

Perusall Integration Setup in D2L

Setting up your course

1. Go to Content (main navbar) in one of your courses and pick an existing module or create a new one.
2. In that module, click the **Add Existing Activities** button, and select External Learning Tools from the drop-down menu.
3. Click on **Perusall** to add the External Learning Tool to the module. **Note:** If you do not see it listed, use the search bar.

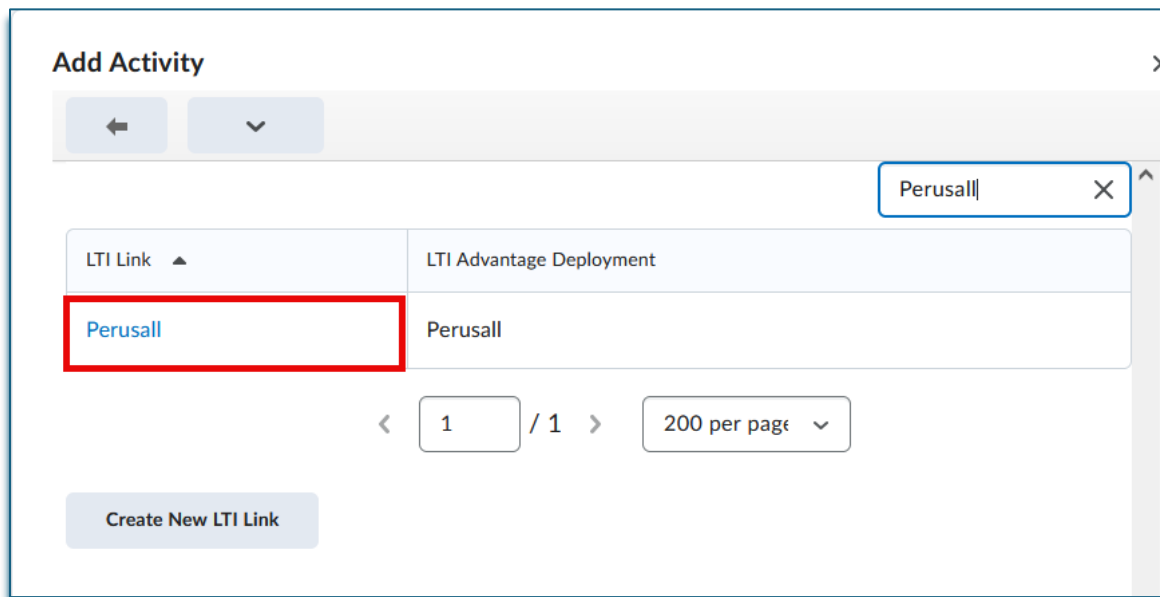

4. Select **Edit properties in place** in the dropdown next to the newly created link and check **Open as External Resource**.
5. Reload the page.
6. Click on the Perusall link.
7. Perusall will launch in a new window. A course will be created that is connected to your D2L course. If you have already set up an account, Perusall will send you an email to confirm connection to D2L. Click on the link in your email to confirm.
8. In your newly-created Perusall site, set up your readings and assignments. A tour of the features will be presented to you when you first enter the course. You can exit the tour at any time. Complete the five steps to set up your course: 1)

Welcome, 2) Select Content (this step can be completed after course setup), 3) Student Cost, 4) Basic settings (department selection required), 5) Ready to go! (click on **Continue to Library** located in the lower right-hand corner of page).

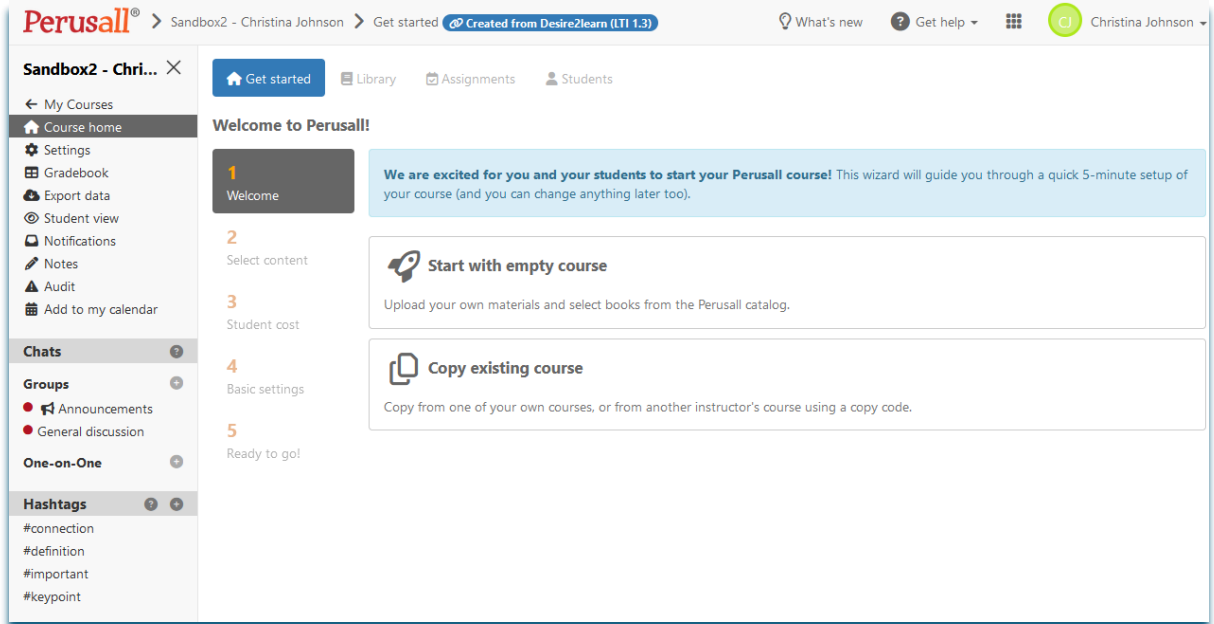

Add Readings

To add readings, click on **Course home > Library > Add Content**. A list of options will appear on the right-hand side (e.g., Document, Web page, Quiz, Video, Podcast, etc.)

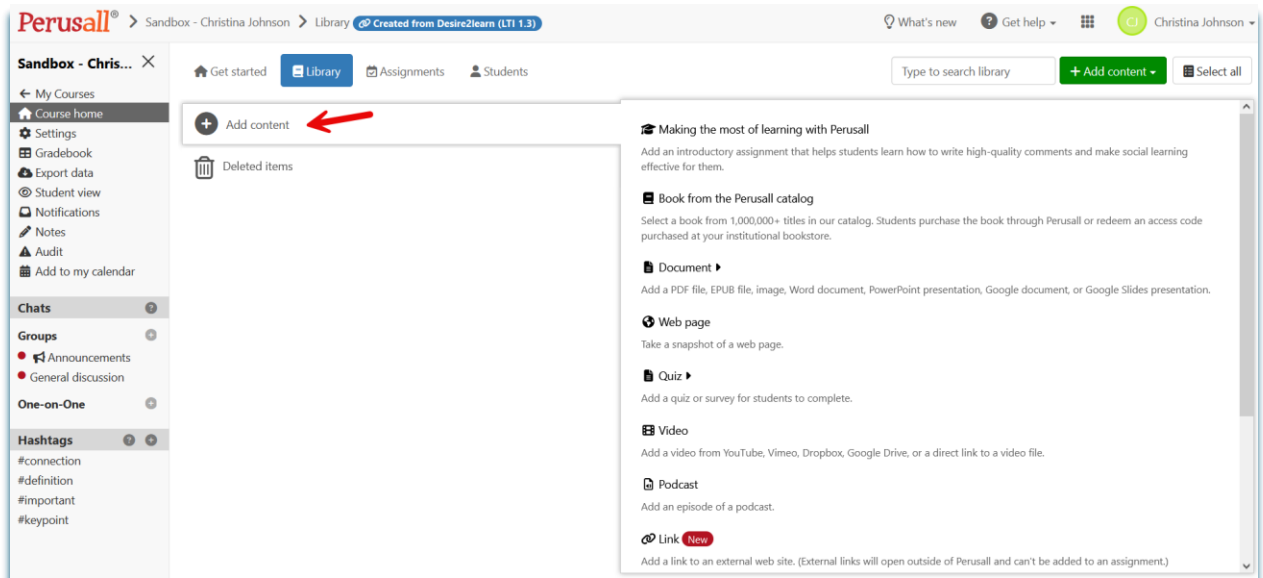

Add Assignments

To add an assignment, click on **Course home > Assignments > Add assignment**. An optional introductory assignment provided by Perusall is available to assist your students with learning the platform. Complete instructions for **Content, Options** and **Scoring** tabs within Assignments setup and click **Save** changes.

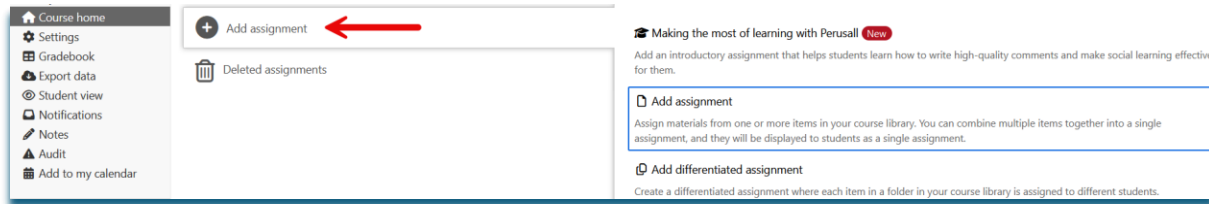

For each assignment in Perusall (optional)

It is not necessary to create separate assignment links because with the LTI 1.3 integration, Perusall creates gradebook columns in D2L for each Perusall assignment automatically. However, if you still would like these individual assignment "deep links" present in your D2L course site, follow these instructions:

1. In Perusall, click on the **Settings** tab > **Scoring** > **LMS grade sync**.
2. Change the dropdown menu selection for [LMS grade column management](#) to **Instructor creates deep links in LMS; no Perusall gradebook columns will appear in LMS until deep links have been created**
3. Click **Save Changes**.
4. Navigate to Content in your D2L course to select a module > **Add Existing Activities**. Select **Perusall Assignment link** from the dropdown menu options to select the Perusall assignment [1] and click **Link to this content** [2].

